



Information in advance for your bike tour

Soon it will be time for your cycle dreams to come true! On the following pages we would like to provide you with some useful information in advance. We already wish you lots of fun with your upcoming bike tour.

GENERAL INFORMATION

This letter provides general information about your booked bike tour. Your travel documents (one package per room) will be stored at the start hotel. Please ask for it at the hotel reception.

Please note: Any applicable spa and local taxes or tourist taxes are not included in the tour price and must be paid in cash at the hotel.

If you arrive after 6 p.m., please give the hotel a short call, so they are informed!

If you have booked half board and the restaurant is not directly at your accommodation, we have reserved a table for you in a restaurant nearby. You will find the voucher with time details in your travel documents.

ARRIVAL HOTEL

Arte Hotel Krems

Dr. Karl Dorrek-Str. 23

3500 Krems

www.arte-krems.at/hotel/das-hotel

+43 2732 711-23

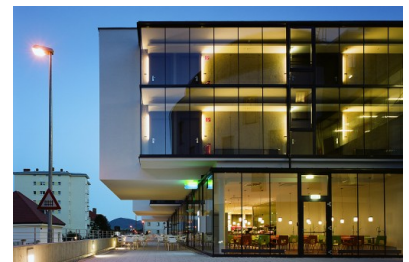

Hotel Steigenberger

Am Goldberg 2

3500 Krems

www.steigenberger.com/hotels/alle-hotels/oesterreich/k

+43 2732 71010



ARRIVAL BY CAR AND PARKING

Arte Hotel Krems: Public underground parking garage of Campus Krems directly under the Arte Hotel for a reduced fee of approx. € 24.00 per day and car.

Hotel Steigenberger: Car park for a fee of approx. € 16.00 per day and car, no reservation possible, subject to availability. Payable on site!

ARRIVAL BY TRAIN

Arte Hotel Krems: Krems main railway station, approx. 2 km from the hotel.

Hotel Steigenberger: Krems main railway station, approx. 2,5 km from the hotels.

ARRIVAL BY PLANE

The nearest major international airport is Vienna (Schwechat). From here you can take the train directly to Krems via Vienna (<https://www.oebb.at/>). A cab for a one-way trip costs approx. 170 €.

TRAVEL DOCUMENTS

We have left your personal travel document package for you at the reception of your starting hotel. If you have booked bikes, they will be waiting for you at the start hotel. (Please ask at reception).

Each package contains:

- Latest hotel list (valid as voucher for your hotels)
- Maps with route description
- Vouchers, tickets for additional services (if included or booked)
- Luggage tags

LUGGAGE TAGS

You will receive **luggage tags** for your suitcases at **your start hotel**. Please fill in the luggage tags and label each piece of luggage with a tag. Your booking name should already be pre-printed in the right-hand field. In the left-hand field, please enter the **total number of items of luggage** to be transported under this name. In the following-mentioned sample, the guests 'Mustermann' (10 people) have 12 pieces of luggage. If the number of pieces of luggage changes during the tour, please update this on **all** luggage tags.



LUGGAGE TRANSFER

On our tours you travel by bike and we transport your luggage from hotel to hotel. Please note the following to ensure that everything runs smoothly:

- You will receive Pedalo luggage tags with your travel documents at your start hotel. Your **booking name** is already printed on these. All you have to do is enter **the total number of pieces of luggage** to be transported under **your booking name**.
- A suitcase may not scale more than 20 kg. It is better to pack an additional bag. (Open bags, glass bottles or similar items cannot be transported).
- Please deposit your luggage at the reception of your accommodation each morning by **9 a.m.** at the latest.
- You will receive your luggage at the next hotel by 6 p.m. at the latest. In case your luggage does not arrive in time, you will be informed by the hotel reception.

If your luggage is lost or damaged, we are only liable if this was caused by us and is reported to us immediately after it occurs, but even then only up to a maximum of € 200,- per person. We do not accept any liability:

- for items such as laptops, tablets, etc., valuables of any kind that are not usually carried in luggage
- for means of payment of any kind
- for visual damage
- for damage to handles and wheels
- for damage to items of luggage whose total weight exceeds 20 kg

Note: Please hand out your room key to the reception at check-out and make sure that you have not forgotten your bike key in your luggage! Luggage transport ends on your last cycling stage at the booked hotel.

HOTEL LIST

On your hotel list you will find the booked accommodations, type of room and services (like breakfast, dinner,...). It is your voucher for the hotels.

CLOTHING

We recommend, not to wear clothing with tight seams and buttons. It is also recommended to wear special padded cycling shorts as well as a cycle helmet.

If you need a helmet, this has to be booked through your tour operator at least one week before arrival (rental helmet € 19,- / purchase helmet € 49,-).

On hot days, it is advisable to wear hat, sun cream and sunglasses. Don't forget your swimsuit for any swimming opportunities along the route!

TIP: You should also always carry rainwear and spare clothing in your saddlebags.

BIKES

A bicycle of prime quality is most important for a successful cycling holiday. Therefore we use solid quality for all components and in the production, on basis of proven and tested quality. That way we are able to guarantee best comfort and safeness on roads and bike paths.

- Our bikes are branded touring bikes, smooth-running, equipped with 21-speed derailleur gears and freewheel. On request, we can also provide 7-speed unisex bikes with hub gears, coaster brake and 2 V-brakes.
- Our electric bikes are pedelecs with a pedal-assisted electric motor up to 25 km/h. They are 28-inch bikes (unisex) with 8-speed hub gears incl. LCD display, bike computer and power consumption display.
- Our premium bike is a sporty 27-speed with freewheel and crossbar. Equipped with hydraulic Magura HS 11 brakes and Shimano Deore XT gears, as well as a high-quality Suntour suspension fork.
- All bikes are equipped with a comfort gel saddle (with a seat post diameter of 27,2 mm).

Please note that GPS device is not part of the standard equipment of our bikes.

Of course, the complete equipment also includes suitable accessories - optimally matched to our bikes and particularly robust and solid, only from well-known quality manufacturers:

- Saddle bag (water-repellent)
- Handlebar bag (water-repellent)
- Tool/repair kit (with spare inner tube) for small independent repairs, for larger breakdowns please contact the service hotline or the office hotline directly
- Air pump
- Combination lock

You can leave the rental bikes in the last hotel at a place provided by the hotel management.